

CONVENZIONE REPERTORIO N.108 DEL 15.02.2021
REGISTRO CONVENZIONI REGIONE MARCHE

REALIZZAZIONE DI UNA ROTATORIA
all'incrocio tra la
S.S. 16 "Adriatica" e la S.P. 224 "Paludi"

CUP C61B19000310001
IMPORTO COMPLESSIVO DEL FINANZIAMENTO € 800.000,00

arkteam

arch. Alessio Marini
arch. Andrea Chiappetti
RELAZIONE GEOLOGICA- Dott. Geol. Costantino Berardini
RILIEVO TOPOGRAFICO- Geom. Giovanni Antolini

IL RESPONSABILE DEL PROCEDIMENTO: ING. IVANO PIGNOLONI

ELABORATO:
STATO RIFORMATO

A-2
SCALA:
1:200

| 03 | | | | | |
|------|-------------|------------|---------|------------|-----------|
| 02 | | | | | |
| 01 | | | | | |
| 00 | | Sett. 2022 | | | |
| REV. | DESCRIZIONE | DATA | REDATTO | VERIFICATO | APPROVATO |

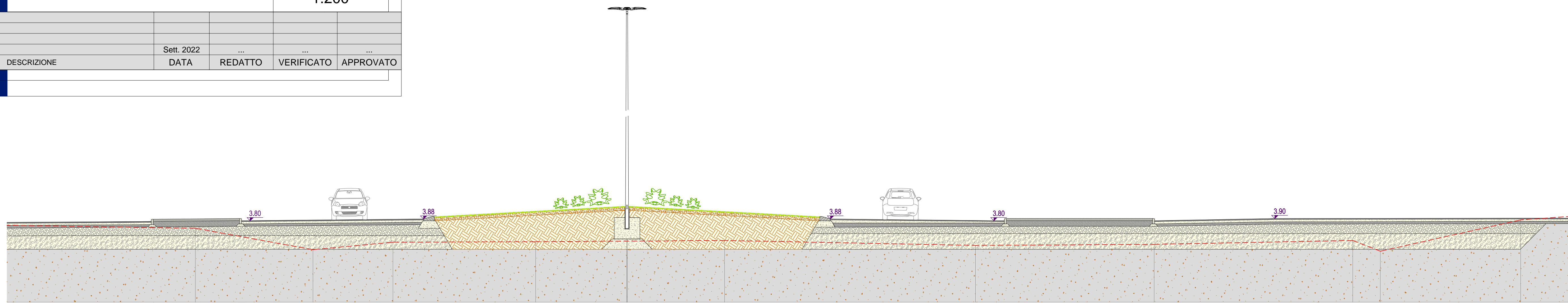


Sezione A-A - scala 1:100

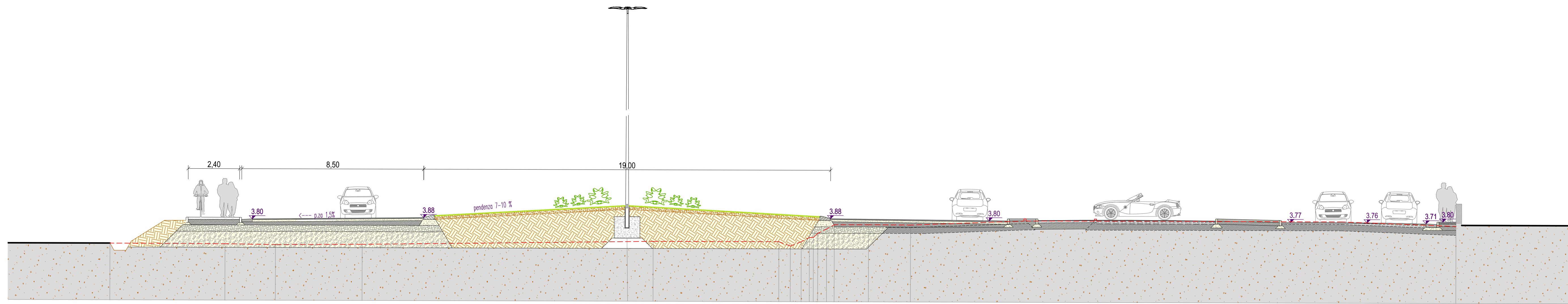

Sezione B-B - scala 1:100

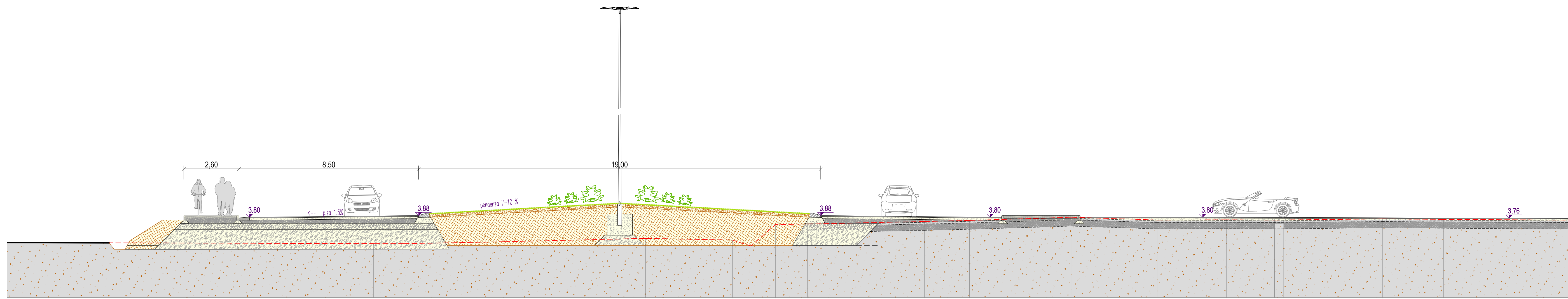

Sezione C-C - scala 1:100

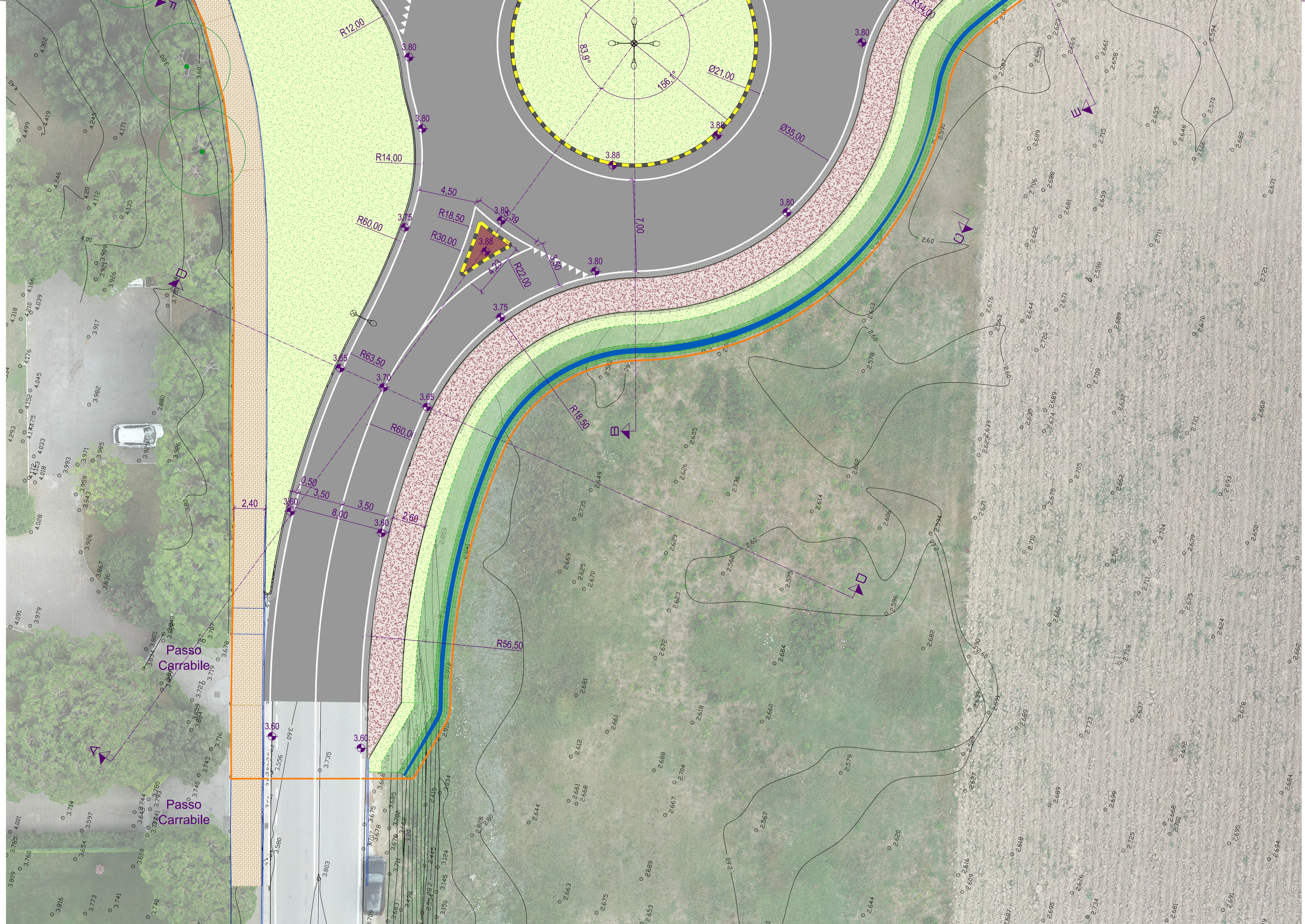

Dettaglio stradale 1:10

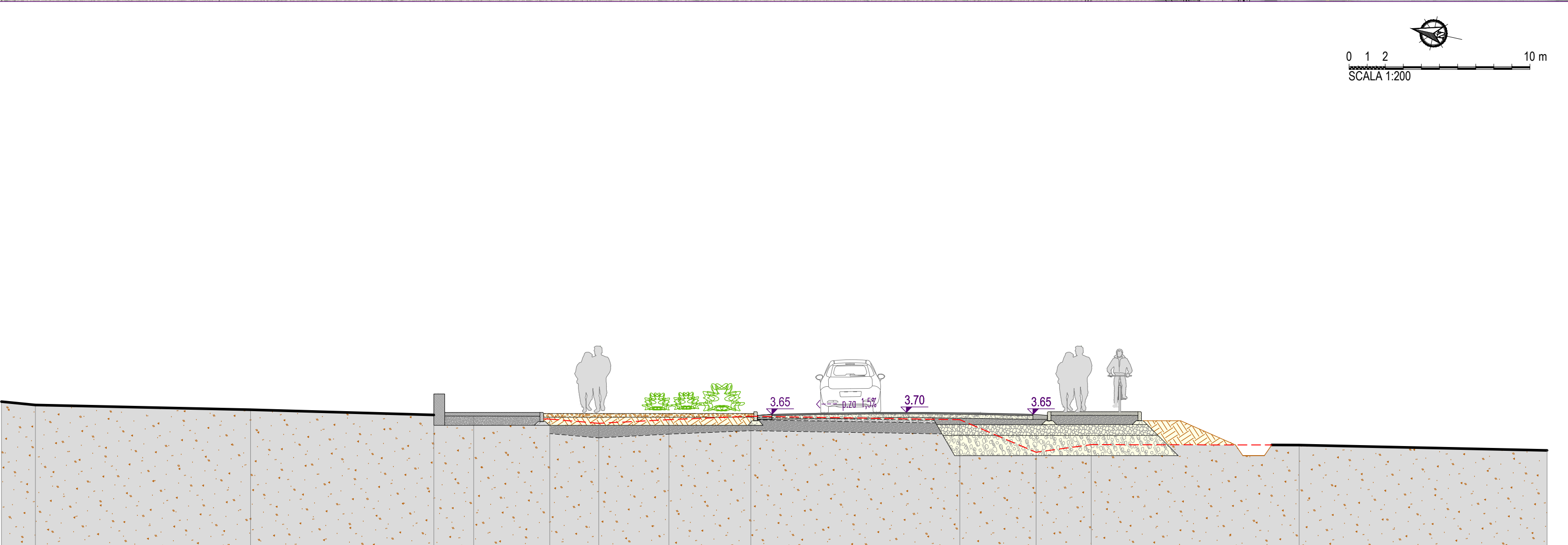
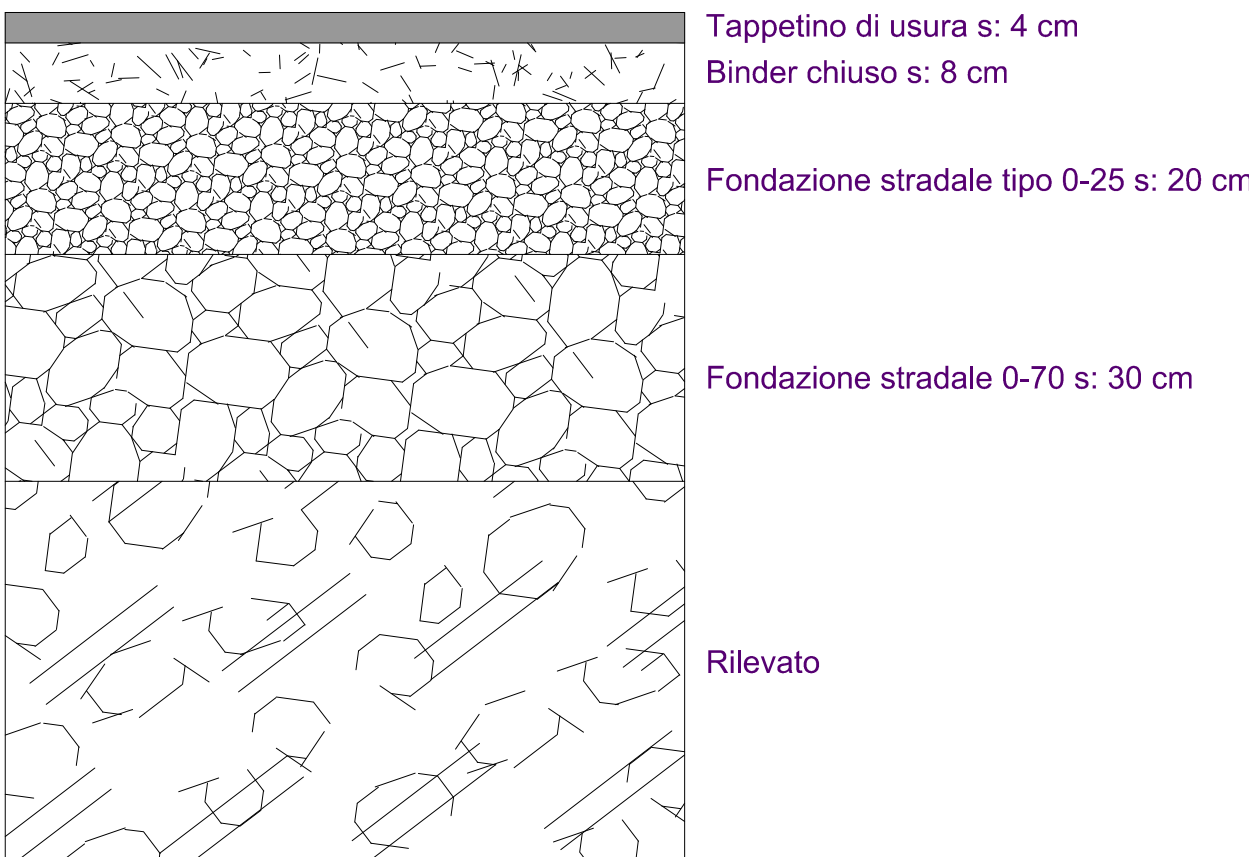

Sezione D-D - scala 1:100

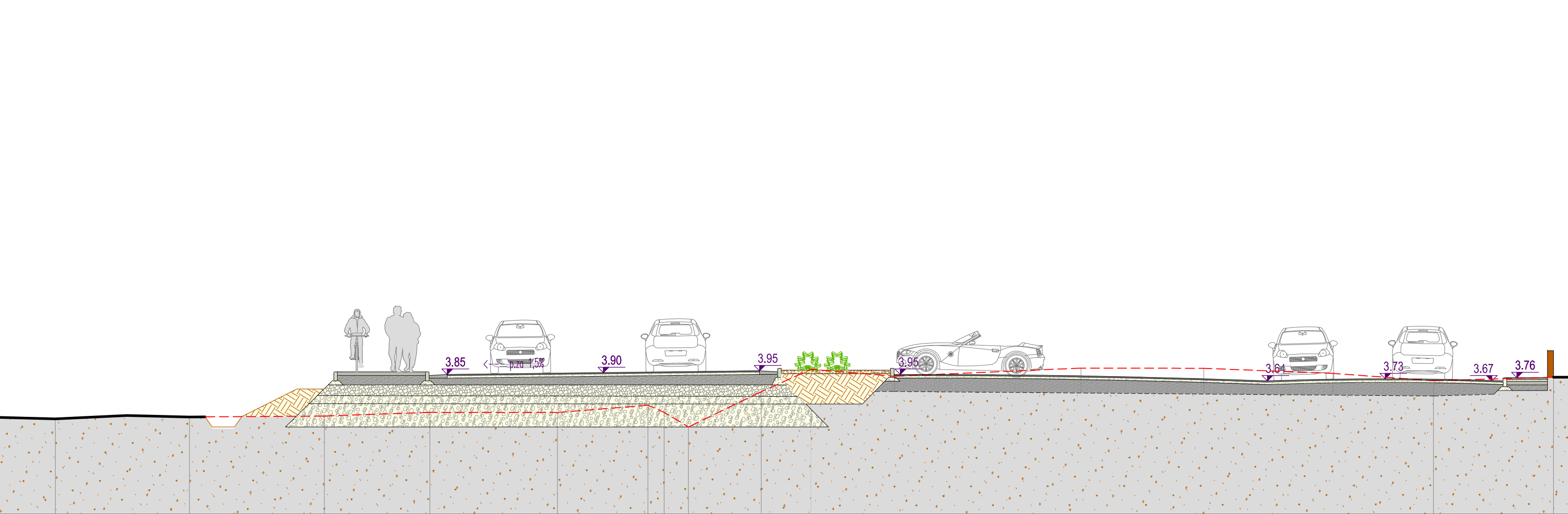

Sezione E-E - scala 1:100

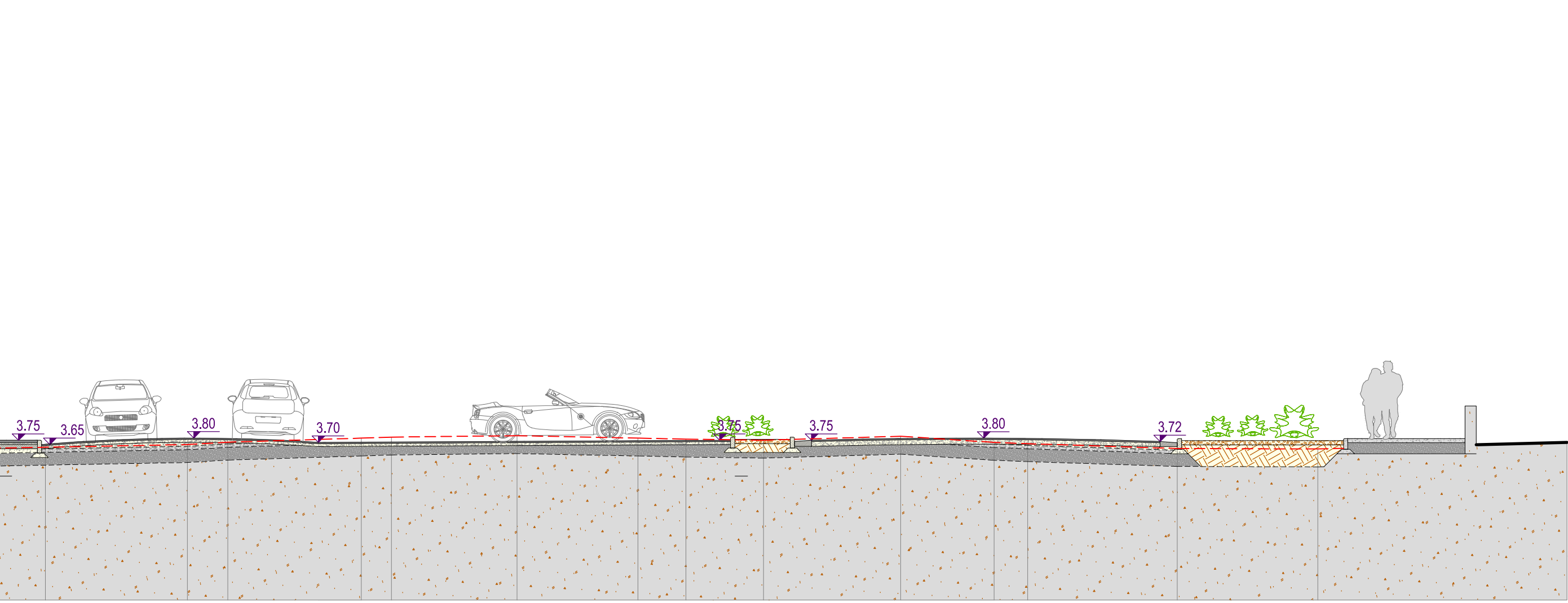

Sezione F-F - scala 1:100